

DIN 912 Vented Socket Capscrews

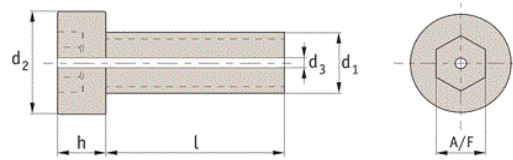

DIN 912 Vented Socket Capscrews								
Diameter-d1	M3	M4	M5	M6	M8	M10	M12	M16
d2	5.5	7	8.5	10	13	16	18	24
d3	1.2	1.5	1.5	2.0	2.0	3.0	3.0	3.0
h	3	4	5	6	8	10	12	16
A/F	2.5	3	4	5	6	8	10	14
	Lengths							
	5	5	6	8	12	16	30	25
	To	To	To	To	To	To	To	To
	16	35	40	50	60	60	60	60

Material: A2 Stainless Steel

INFORMATION AND DRAWINGS PROVIDED ARE FOR REFERENCE ONLY